

LOVE WHERE YOU LIVE



# BOWFIELD HALL

BOWFIELD ROAD • WEST KILBRIDE

**Milestone**  
Developments

[www.milestonedevelopments.co.uk](http://www.milestonedevelopments.co.uk)



# WELCOME TO BEAUTIFUL WEST KILBRIDE

---

LOVE WHERE YOU LIVE

Bowfield Hall is a quality new development of wonderfully detailed detached family homes, situated on the highly sought after Bowfield Road, West Kilbride, backing on to the picturesque Glen.

With a choice of outstanding house types this luxury development of quality homes offers an unrivalled specification and introduces a whole new choice of stylish family living for this idyllic part of West Kilbride.

West Kilbride nestles on the hillside beneath Law Hill and Tarbert Hill overlooking the Firth of Clyde. In 1315, a year after Bannockburn, Robert the Bruce gifted the area to Sir Robert Boyd of Kilmarnock and it was around 1360 that Portencross Castle was built.

Perfectly located on the edge of the village, this unique new development of modern family homes defines affordable luxury and offers convenience to Glasgow via road and

rail. West Kilbride was recently designated Scotland's Craft Town, and was recognised as one of the country's most creative places. The Craft Town of West Kilbride, together with scenic Seamill and historic Portencross, provide a great day out for locals and visitors looking for walks, wildlife, scenery and Scottish crafts.

For those interested in sporting, leisure and recreational facilities, the location of Bowfield Hall is ideal. There is a beautiful links course at West Kilbride Golf Club, a bowling club and a local football club. The surrounding area also boasts Kirktonhall Glen, and the Ayrshire Coastal Path which offers uninterrupted views of Arran along with many species of seabirds.

The ideal location of Bowfield Hall ensures that residents could not be better placed to enjoy all the superb facilities that this wonderful part of Ayrshire has to offer.





## A WONDERFUL HAVEN ON THE EDGE OF THE BEAUTIFUL AYRSHIRE COAST

Explore the great outdoors - Bowfield Hall is perfectly located to cater for all outdoor pursuits - water sports on your doorstep, hiking and cycling in the beautiful Clyde Muirshiel National Park but to name a few.





## **SOMETHING FOR EVERYONE!**

**The local area caters for all ages and interests. There is superb golfing on the Ayrshire Coast including West Kilbride Golf Club, Royal Troon and Prestwick.**

**Nearby Largs includes the Vikingar sports centre which has a pool and other leisure facilities, whilst the exclusive Seamill Hydro boasts one of the best Spas in Ayrshire.**



**Superb restaurants, shopping, crafts and entertainment venues complete the local offering and the coastal atmosphere makes this area a real gem!**



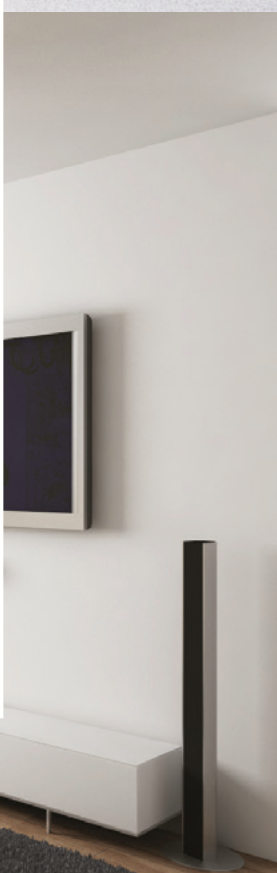

## SPECIFICATION

- High quality kitchen units with choice of doors, handles, work tops and upstands
- Integrated appliances to include gas hob, electric oven and extractor hood
- Contemporary white sanitary ware with chrome fittings
- Extensive choice of wet wall to showers, tiling above baths and tiled splash back above sinks
- Internal walls and ceilings painted white throughout
- Mains supply smoke detectors & CO detectors
- Moulded skirting and architraves
- Painted internal doors with quality ironmongery
- Comprehensive range of electrical sockets, switches, TV and telephone points
- Gas central heating
- All front gardens to be turfed. Rear gardens topsoiled
- Composite front doors
- uPVC double glazed windows with lockable system
- Boundary fencing to side and rear
- Feature external lighting to front and rear doors
- Driveways tastefully finished in mono block paviors
- Garage where applicable
- Bi-fold doors where applicable
- NHBC 10 year warranty







**LIFE IN A BEAUTIFUL  
COASTAL SETTING**



**At Milestone we never forget  
that a home isn't just where you  
live, it's how you live.**

**We care about the things you  
care about.**

**We care about you.**







**The surrounding coastline is  
simply stunning**



# BOWFIELD HALL

## THE CARNEGIE

Total Floor Area 1075 sq ft (1221 sq ft inc garage)



3D render is for illustrative purposes only and as such the finishes may vary on site

LOVE WHERE YOU LIVE

### GROUND FLOOR

|                              |        |         |
|------------------------------|--------|---------|
| Entrance Hall & WC / Utility |        |         |
| Lounge                       | 15'4"  | x 11'5" |
| Kitchen / Dine               | 19'6"  | x 8'3"  |
| Garage                       | 16'10" | x 7'10" |

### FIRST FLOOR

|                |       |        |
|----------------|-------|--------|
| Master Bedroom | 13'3" | x 9'6" |
| Ensuite        | 5'6"  | x 5'3" |
| Bedroom 2      | 13'3" | x 8'3" |
| Bedroom 3      | 9'2"  | x 8'4" |
| Bedroom 4      | 9'0"  | x 8'4" |
| Bathroom       | 8'4"  | x 5'4" |

### THE CARNEGIE

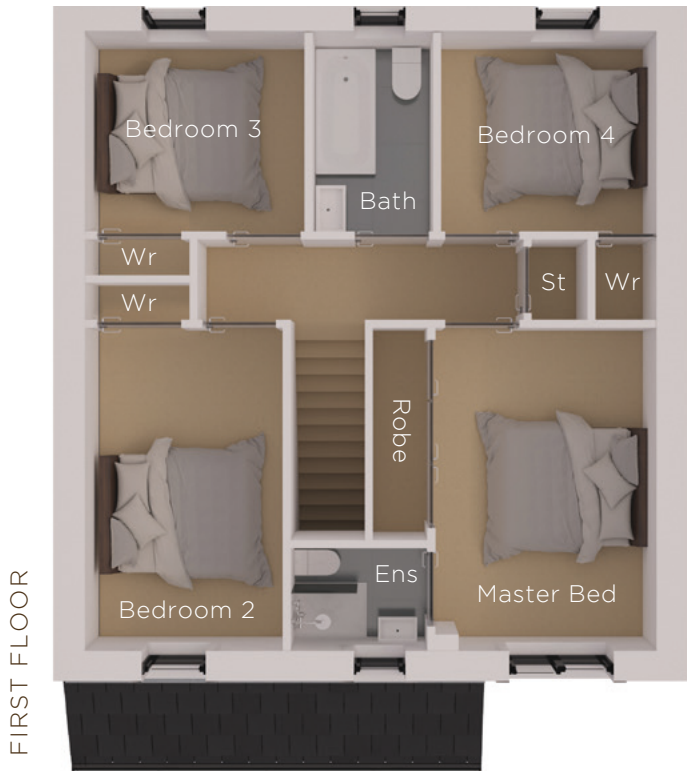

3D floor plans are not to scale and all dimensions are approximate



# BOWFIELD HALL

## THE CARNELL

Total Floor Area 1378 sq ft approx



3D render is for illustrative purposes only and as such the finishes may vary on site

LOVE WHERE YOU LIVE



GROUND FLOOR

|                    |       |         |
|--------------------|-------|---------|
| Entrance Hall & WC |       |         |
| Lounge             | 15'0" | x 12'9" |
| Kitchen / Dine     | 22'0" | x 10'0" |

FIRST FLOOR

|           |       |         |
|-----------|-------|---------|
| Bedroom 2 | 12'9" | x 11'1" |
| Bedroom 3 | 10'0" | x 10'0" |
| Bedroom 4 | 10'0" | x 10'0" |
| Bathroom  | 9'7"  | x 6'7"  |

SECOND FLOOR

|                |       |         |           |
|----------------|-------|---------|-----------|
| Master Bedroom | 17'6" | x 11'0" | at widest |
| Ensuite        | 6'4"  | x 6'4"  |           |
| Dressing       | 11'5" | x 5'2"  |           |

3D floor plans are not to scale and all dimensions are approximate



# BOWFIELD HALL



- THE CARNEGIE
- THE CARNELL
- THE DRUMLANRIG



Site Layout (not to scale)



Tel: 01292 834040  
www.milestonedevelopments.co.uk



Tel: 01292 262777  
www.rightmove.co.uk



**Milestone**  
Developments

www.milestonedevelopments.co.uk  
Tel: 01292 834040

Sat Nav  
Bowfield Road  
West Kilbride  
KA23 9JZ

These particulars do not constitute any part of an offer or contract. None of the statements contained in these particulars are to be relied on as statements or representations of fact and intending purchasers must satisfy themselves by inspection or otherwise as to the correctness of each of the statements contained in these particulars. All measurements of area are quoted as Net Sales Area which is calculated in accordance with the RICS Code of Measuring Practice (6th Edition) APP21. Configures of kitchens, bathrooms and wardrobes may be subject to alteration from those illustrated without prior notification. Purchasers should satisfy themselves as to the current specification at the time of booking.

The Vendor does not make or give, and neither the Selling Agent, nor any person in their employment, has any authority to make or give any representation or warranty whatever in relation to any property. Artist's impressions and internal photographs are for illustration only. Plans are not to scale and all dimensions shown are approximate E. & O. E.